

Clos   
de Vessy

Sales brochure







Project conceived and designed by the *Carneiro Architectes* office.







# THPE architect villas in Vessy

## **AUTHORISATION IN EFFECT!**

We invite you to discover the **Clos de Vessy**, on Chemin de la Place-Verte 35. This exclusive project consists in the construction of two semi-detached, THPE, turnkey villas, conceived and designed by the *Carneiro Architectes* office.

The project is on a nice 1'480 sqm wooded plot, in a residential neighbourhood on the Vessy plateau, close to an agricultural zone.

Distributed on three levels, including a furnished basement, each villa has a gross floor area of 323 sqm and a plot ranging from approximately 696 to 784 sqm.

- Usable surface of 265 sqm
- Four bedrooms including a master suite with dressing room and bathroom
- Furnished basement with natural light provided by a large patio

**Delivery scheduled for end 2024**









# Environment.



## Schools

- Pinchat School
- Catholic Institute La Salésienne

## Restaurants

- Restaurant Il Mirtillo
- La Chaumière

## Shops

- Migros Carouge
- MParc – La Praille
- Veyrier shops

## Transport

- TPG 41 line from Carouge to Chêne-Bourg



# Villa A - sold.



Orientation south-west

Plot 784 sqm

Levels 3

Gross floor area 323 sq m

Usable surface 265 sqm

Terraces 35 sqm

Garden 399 sqm

Garage for two cars

# Villa B - available.

Orientation south-east

Plot 696 sqm

Levels 3

Gross floor area 323 sq m

Usable surface 265 sqm

Terraces 35 sqm

Garden 394 sqm

Garage for two cars

Sale price upon demand

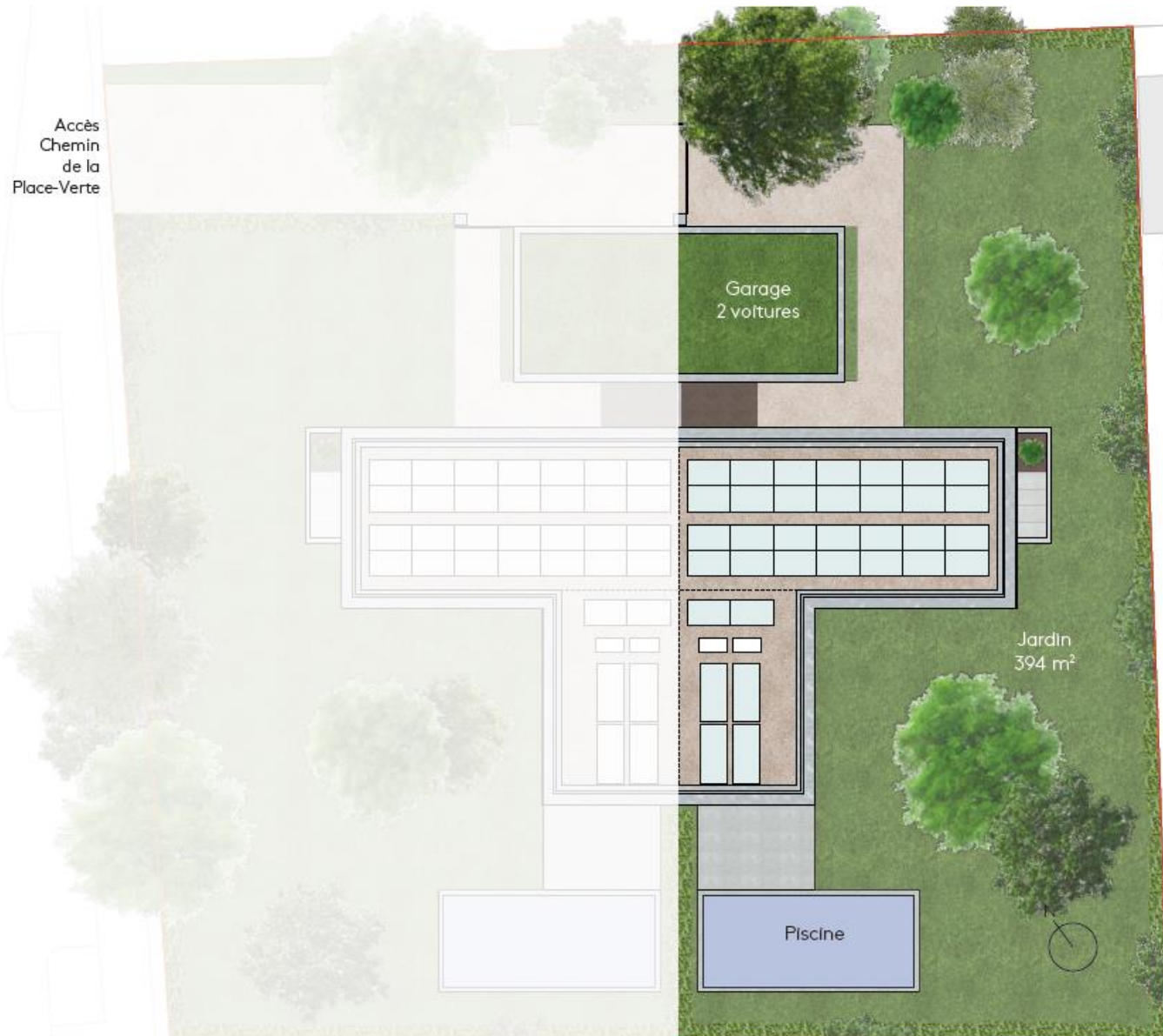





# Features.



🏠 **Gross floor area**  
**323 sqm**

🏠 **6 rooms**

🛏️ **4 bedrooms**

🛁 **3 bathrooms**

📅 **Delivery**  
**scheduled end**  
**2024**

---

**Sale price upon demand**







## Naef Prestige Knight Frank

Route de Florissant 57  
1206 Genève



For viewings or more info

T. +41 22 839 39 60  
[geneve@naefprestige-knightfrank.ch](mailto:geneve@naefprestige-knightfrank.ch)

Dedicated website:  
[clos-vessy.ch](http://clos-vessy.ch)